

Plat of Survey

of

Lot 69 of The Fields of Delavan,

a subdivision located in the Northwest 1/4 and the Southwest 1/4 of the Southwest 1/4 of Section 13, Town 2 North, Range 15 East, City of Delavan, Walworth County, Wisconsin.

Surveyed for: **Henry Keizer**
W7942 Creek Road
Delavan, Wisconsin. 53115

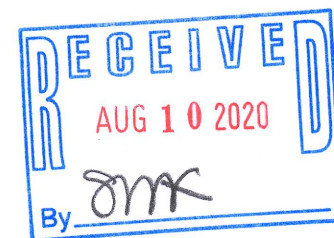
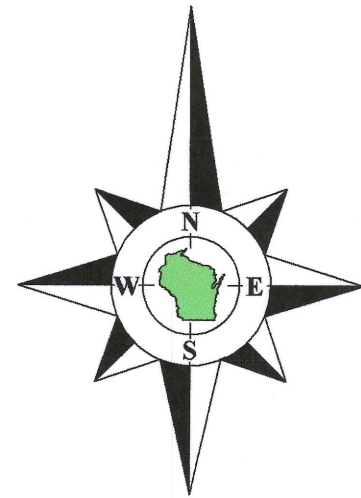

Bearings referenced to the North line of Birchwood Street,
recorded as N88°40'00"E on the plat of The Fields of Delavan.

Betzer Road
(66' Wide)

recorded as(N1°20'00"W 501.47')
N1°19'08"W 501.44'

Found pipe
leaning N.

Found pipe
leaning 0.14'
S. & 0.30' E of
corner - RESET

recorded as(N1°20'00"W 75.00')
N1°19'08"W 75.00'

Lot 69
Tax Parcel
XFI 00069
0.316 Acre
13,778 Sq.Ft.

Lot 68

recorded as(N88°40'00"E 153.64')
N88°40'00"E 153.64'

Wood Deck

House
No. 1511

Lot 2
Block 6
First Addition
to Chestnut Ridge
Subdivision West

Lot 1
Block 6
Chestnut Ridge
Subdivision West

recorded as(N1°19'09"W 90.00')
S1°18'19"E 90.00'

Birchwood Street
(66' Wide)

recorded as(S88°40'00"W 138.62')
S88°40'00"W 138.62'

Concrete Curb & Gutter

Copyright ©2020 by Olson Land Surveying, LLC.

All rights reserved. No part of this survey plat may be reproduced or transmitted in any form by any means - graphic, electronic, or mechanical, including photocopying, tracing, or information storage and retrieval systems - without permission in writing from Douglas G. Olson, Olson Land Surveying, LLC.

I hereby certify that I have surveyed the above described property in compliance with Chapter A-E 7 of the Wisconsin Administrative Code and that the map hereon is correct to the best of my professional knowledge and belief and shows the size and location of the property, its exterior boundaries, the location and dimensions of all visible structures thereon, boundary fences, apparent easements and roadways and visible encroachments, if any.

This survey is made for the exclusive use of the present owners of the property, and also those who purchase, mortgage or guarantee title thereto, within one year from the date hereof.

Douglas G. Olson
Wisconsin Professional Land Surveyor - 2093

Notes:

- 1) This Plat of Survey is not certified unless signed and sealed in red ink.
- 2) This survey is subject to Wisconsin lien laws. This Plat of Survey is the notice of intent to file lien. Lien waiver required.
- 3) The Survey Date shown on this Plat of Survey is the completion date of the field work.

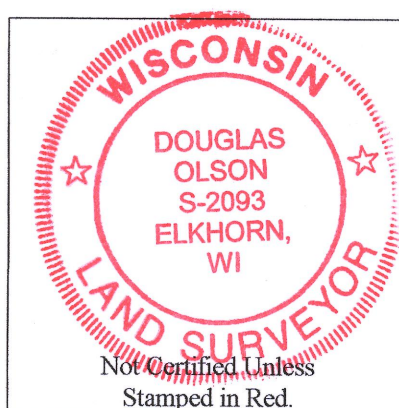

45 South Wisconsin Street | P.O. Box 322
Elkhorn, Wisconsin. 53121
Telephone: (262) 723-3434
Facsimile: (262) 723-8044
Email: doug@olsonsurveying.com
Website: www.olsonsurveying.com

OLSON
LAND SURVEYING, LLC
Rural | Residential | Commercial

Legend of Symbols & Abbreviations
North
South
East
West
Found Iron Pipe, 1" dia.
Found Iron Pipe, 1-3/16" dia.
Found Iron Rod, 1" dia.
Recorded Information
Light Pole
Manhole
Catch Basin
Hydrant
Concrete Surface
Brick Pavers

Sheet 1 of 1 Sheets
Job Reference Number
2020.095

2020.095

Survey Date: August 6, 2020.
Revisions:

